

ENIECCBPOM45210332AV

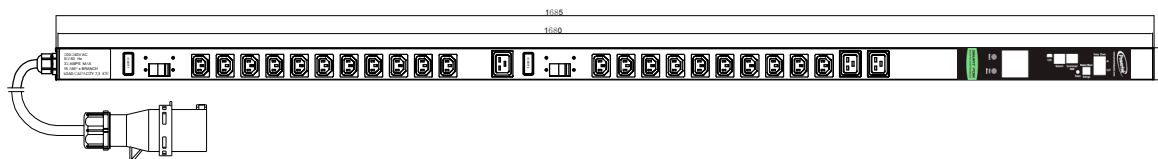

FEATURES	
Technology	POM (Per outlet Monitoring)
Energy Metering	Voltage (V), Current (A), Active Power (kW), Real Power (kVA), Power Factor
Metering per Input Line	Yes (Branch Circuit and Total Current)
Metering per Output Receptacle	Yes
Remote Outlet Switching	No
Environmental port	Yes
Networking	HTTP(s); SSH; RS-485 (Serial); Power IQ; SNMP v1/v2/v3; SMTP, MODBUS
Remote Management	Yes
Daisy Chain	Yes
Display	Yes (LCD selectable Display)
Environmental Sensors	All in one Temperature and Humidity sensor with 2 digital inputs (for connect air flow, door sensor, water leak, smoke detector and Vibration sensor)
INPUT	
Plug	IEC 60309 1 P+N+E 32A 250V SINGLE PHASE
Lead length	3 Meters
Cable type	H07RN-F3G4.0 mm ²
Max. Input Load	32A
Rated Input voltage	190-240V Single phase
Frequency	50-60Hz
Power capacity	7,3KW
OUTPUT	
Rated Output voltage	190-240V Single phase
Output types	21 IEC 60320 C13 (10Amps) + 3 IEC 60320 C19 (16Amps)
Overload Protection	2 Single Pole Magnetic Hydraulic CB 16A
CHASIS	
Dimensions (W x D x H)	1685 x 72 x 50 mm
Color	Black powder coat
Mounting Options	IPFIX001; IPFIX002; IPFIX003
OPERATING ENVIRONMENTAL	
Temperature Range	0° to 60° C (30° to 140° F)
Relative humidity	0 - 95 %
Elevation	0 - 4000 Meters
CONFORMANCE	
CE, RoHS Compliant, IEC 60950-1	

Copyright 2015 -

RoHS Compliant

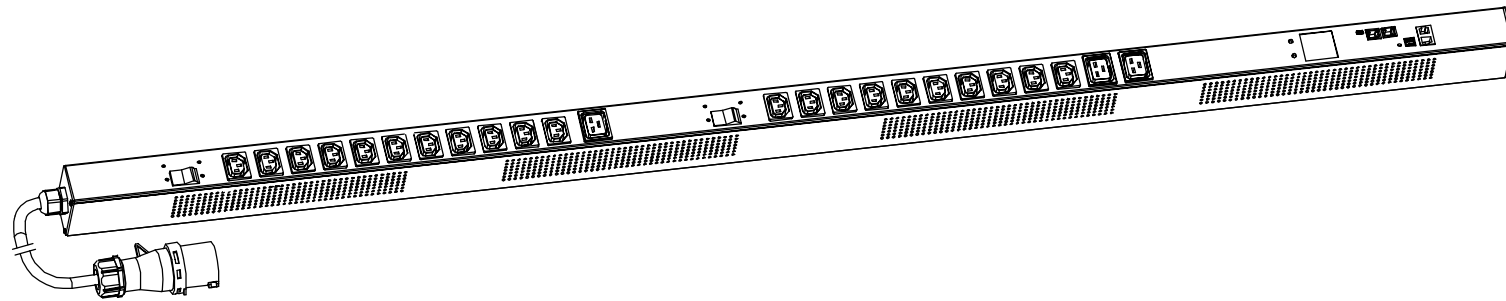
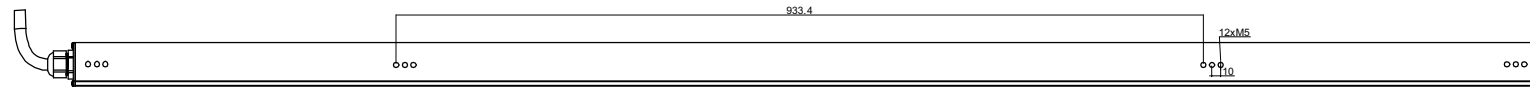
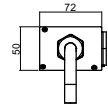
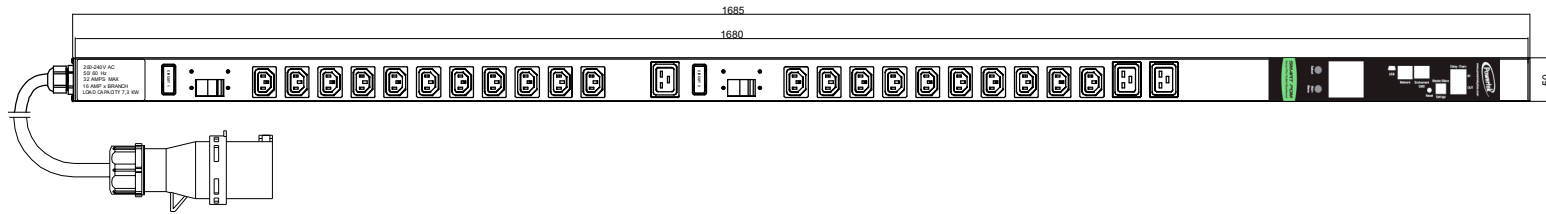

POM Series Inlet Power monitoring Per outlet monitoring Environmental monitoring	OUTPUT (21) IECC13 Socket (10A Rated) (3) C19 Socket (16A Rated)	OPERATING TEMPERATURE 0° to 60°C
INPUT 250VAC 32A 50HZ 32A Commando plug 3M H07RN-F3G4.0mm Power lead	BRANCH CIRCUITS (2) 1 Pole 16A Hydraulic-Magnetic Circuit Breaker	MOUNTING ACCESORIES (2) IPFIX001 (2) IPFIX002 (2) IPFIX003

Revisions		
Rev	Description	Date

DRAWING TYPE (NO PERMISSION, NO CHANGING)		ENIECCBPOM45210332AV	
unit=mm		Housing	Aluminium
TECHNICAL STANDARD 1.IT11; 2.NO RUSTNESS 3.NO FLAW ON THE SURFACE			Black Powder coating
FILLET	R0.5	DATE 10-11-2015	
ANGLE	±0.5°		
FIRST ANGLE 			
SCALE 1:3			