

Copyright 2017 -

RoHS Compliant

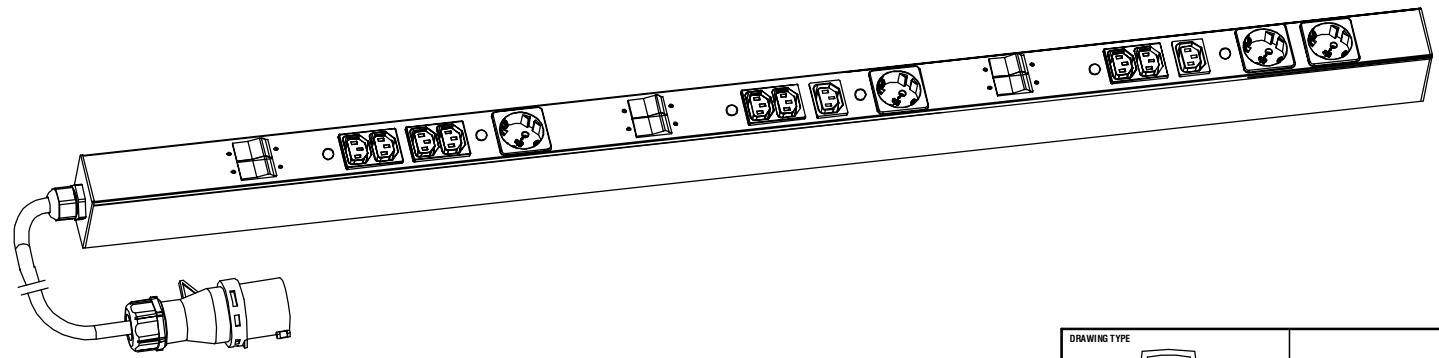
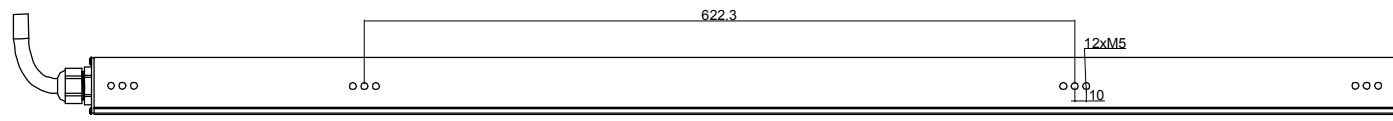
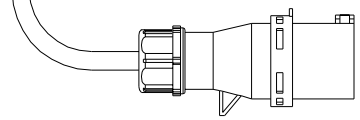
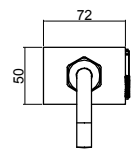
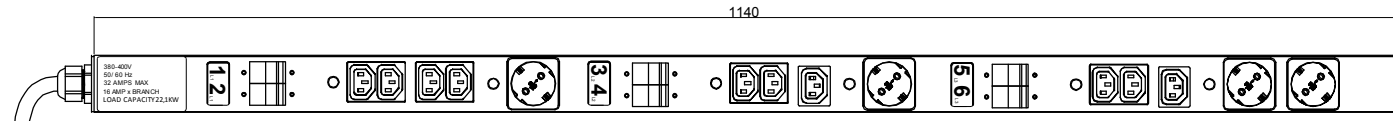

Basic Series (6) Blue LED	OUTPUT (10) IEC 60320 C13 (10A Rated) (4) Schuko Socket (16A Rated)	OPERATING TEMPERATURE 0° to 60°C
INPUT 250VAC 32A 50HZ IEC60309 32A 3Phase plug 3M H07RN-F5G6.0mm ² Power lead	BRANCH CIRCUITS (6) Single Pole Magnetic Hidraulic CB	MOUNTING ACCESORIES (2) IPFIX001 (2) IPFIX002 (2) IPFIX003

Revisions		
Rev	Description	Date

DRAWING TYPE (NO PERMISSION, NO CHANGING)		ENGCNBL45100432A3PV	
unit=mm		Housing	Aluminium
TECHNICAL STANDARD 1.IT11; 2.NO RUSTNESS 3.NO FLAW ON THE SURFACE			Black Powder coating
FILLET	R0.5	DATE 25-04-2017	
ANGLE	±0.5°		
FIRST ANGLE 			
SCALE 1:3		DATE 25-04-2017	